

# SURFACE MOUNT HIGH CURRENT POWER INDUCTORS /SMPI TYPE

## FEATURES

- ◆ Performance low resistance , high current rating.
- ◆ Low loss realized with low RDC.
- ◆ Low core loss.



## APPLICATIONS

- ◆ PDA / Notebook / Desktop, and server applications.
- ◆ DC/DC converters in distributed power systems.
- ◆ DC/DC converter for Field Programmable Gate Array(FPGA).

## ORDERING CODE

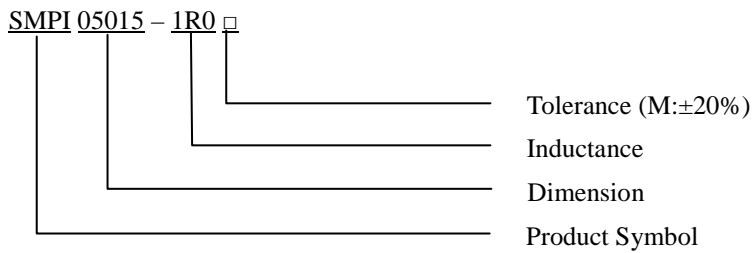

## DIMENSIONS UNIT: mm

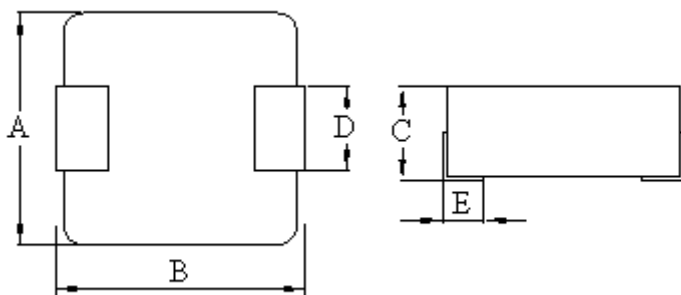

A	5.2 ± 0.3	m/m
B	5.5 ± 0.4	m/m
C	1.5 (MAX)	m/m
D	2.0 (REF)	m/m
E	1.0 (REF)	m/m

# SURFACE MOUNT HIGH CURRENT POWER INDUCTORS /SMPI TYPE

## ELECTRICAL CHARACTERISTICS FOR SMPI 05015

Part No.	Inductance (uH) @(0A)	Test Frequency	Heat Rating Current Irms(A)	Saturation Current Isat ( A ) drop30%	RDC (mΩ) MAX
SMPI05015-R47M	0.47	100KHz/1V	9.0	12	13.5
SMPI05015-R68M	0.68	100KHz/1V	6.0	10	21.0
SMPI05015-1R0M	1.00	100KHz/1V	5.5	8.0	28.0
SMPI05015-2R2M	2.20	100KHz/1V	3.3	5.0	68.0
SMPI05015-3R3M	3.30	100KHz/1V	3.0	5.0	106
SMPI05015-4R7M	4.70	100KHz/1V	2.5	4.0	135
SMPI05015-5R6M	5.60	100KHz/1V	2.2	3.5	150
SMPI05015-6R8M	6.80	100KHz/1V	2.0	3.0	155
SMPI05015-100M	10	100KHz/1V	1.5	2.0	213

Notes:

- 1) You require another part number please contact with us.
- 2) Inductance Tolerance  $\pm 20\%$  ; Frequency Test : 100KHz/1.0v
- 3) All test data is referenced to 25°C ambient.
- 4) Irms : DC current (A) that will cause an approximate  $\Delta T$  of 40°C
- 5) Isat : DC current (A) that will cause Lo to drop approximately 30%
- 6) We can design according to customer's request.



**CORE MASTER ENTERPRISE CO., LTD.**

<http://www.coremaster.com.tw>